

Come join the fun at...

# Hoofstock



Sat & Sun - June 26th & 27th 2010  
Weekend Events & Attractions

**4th Annual FLEA MARKET without the Fleas!** —Bring your own dog-related treasures to sell at the farm this weekend. Think of this as a tailgate-party and set up your items for sale at your own van or SUV; *there will NOT be a separate market area or room for canopy-booths.* You'll be responsible for watching and selling your own items. Competitors and spectators can browse through the parking areas and look for opportunities to purchase new and used equipment, supplies, gifts, treats - whatever. This might be the perfect place to sell your old agility tent, extra dog buckets, camping gear appropriate for trialing, handmade craft items relating to dogs. There is no charge to participate in the flea market — it's offered as an opportunity for all to take advantage of. All sellers are responsible for their own merchandise and sales.

**DO** - sell out of your Car/Truck/SUV/Harley/Scooter/Wheelbarrow . . .  
a small card table next to your vehicle is okay.

**DON'T** - Please don't set up canopies or tents (there's not enough room);  
and absolutely NO live animal sales.

- **PHOTOGRAPHY** - Dick Bruner, widely known for his awesome action herding shots will be on-site all weekend capturing both the action in the arenas along with posed portraits on request. Dick will have his trailer set up on site so you can easily peruse your photos on screen. Photos will be available right on site - no waiting for them in the mail (special orders may take extra time). For more information go to: [www.dicksphotos.us](http://www.dicksphotos.us) or e-mail Dick at [dicksphotos@earthlink.net](mailto:dicksphotos@earthlink.net)

# Hoofstock

Magic's Legacy

AHBA Tests/Trials

&

"Just For Fun - For Exhibition Only" runs

&

4<sup>th</sup> Annual Flea Market

Saturday, June 26, 2010

Sunday, June 27, 2010



SHEEP

GOATS

DUCKS

## American Herding Breed Association Test/Trials

Herding Ranch Dog (HRD-I, II and III)

Ranch Large Flock (RLF-III only)

Herding Trial Dog (HTD I, II & III) Sheep, Goats\* & Ducks

Herding Trial Arena Dog - Sheep, Goats\* & Ducks - Course #2

Junior Herding Dog\* (JHD) † Herding Capability Tested (HCT)

\*Limited Goat Entries- early entry recommended

Pre-Entries OPEN May 1

Pre-entries CLOSE June 12

(Day of Trial Entries - see Entry Form for details)

Magic's Legacy Trial Grounds

W1192 Hwy B, Genoa City, Wisconsin

(South of Lake Geneva at the WI/IL Border)

For more information contact Loralee Van Sluys : [loraleallice@comcast.net](mailto:loraleallice@comcast.net)

**JUDGES** - Anne Jespersen, Stevens Point, WI  
John Wentz, Portage, WI

**Judging assignments:**

SATURDAY - Anne will judge HTAD sheep & goats, HTD sheep & goats, HRD & RLF  
John will judge HTAD ducks, HTD ducks, HCT, JHD

SUNDAY - Judges switch and do opposite classes.

*Maximum total runs each day: 80 - including each day: 10 runs maximum for HRD I, II & III combined; and 6 runs maximum for RLF-III.*



**CLASSES offered BOTH days**



HTAD Course #2 — III, II & I — sheep, goats\* & ducks  
HTD — III, II & I — sheep, goats\* & ducks  
HRD — III, II & I — sheep only (Limit 10 runs/day)  
RLF — III only — sheep only (Limit 6 runs/day)  
JHD and HCT — sheep & goats\*

**\*NOTE:** *Limited Goat Entries- early entry recommended*

**PROPOSED JUDGING SCHEDULE**

Judging starts both days at 8:00 am — Handlers' Meeting before each class.

*One RLF run will start each day, then RLF sheep must rest at least 30 minutes; remaining RLF dogs will run between other classes throughout the day.*

AFTER the first RLF run, one judge will do:

HTAD I, II, III ducks	Duck Arena
HTD III, II & I ducks	Duck Arena
JHD sheep & goats	Gravel Arena
HCT goats & sheep	Gravel Arena

Running concurrently under the other judge will be:

HTAD III, II & I sheep & goats	HTAD Arena
HTD III, II & I goats and sheep	Big Field
HRD III, II & I sheep	Entire Farm

Both Days: HTD-III (S/G) - Ribbon Pull - HTD-III (D) - Shed with 5 (3/2 split)

**AHBA Fees:** Pre-entry \$40.00 per run/per dog. Gate \$45.00. FEO \$25.00

**ENTRIES:** Pre-entries close Saturday, June 12<sup>th</sup>, 2010.

NOTE: Any changes made after the closing date will be subject to an additional \$5.00 administration fee

Gate entries (if room) close ½ hour before each class begins.

**Make checks payable to Magic's Legacy.** Mail entry with fee to:

Loralie Van Sluys, Secretary, 432 Inverrary Lane, Deerfield, IL 60015

**No confirmations will be mailed.** If you do not get in, you will be notified.

ANY questions on entries -- contact Loralie at loraliealice@comcast.net



**PRIZES**

- Rosettes/ribbons for 1<sup>st</sup> - 3<sup>rd</sup> places in each trial class
- Rosette for overall High in Trial Sheep and Duck each day
- Green qualifying ribbons for all test and trial classes
- Prize for overall High in Trial Sheep and Duck each day
- Prize for 1<sup>st</sup> and 2<sup>nd</sup> place in each trial class
- No prizes will be mailed; prizes must be picked up at the trial
- A certificate from AHBA will be mailed to you upon completion of the two required qualifying legs in a class.

**TEST/TRIAL RULES:** Test/Trials are held in accordance with current AHBA rules posted at [www.ahba-herding.org](http://www.ahba-herding.org).

1. Dogs must be 6 months or older for AHBA HCT Tests and 9 months or older for AHBA JHD Tests and all Trial classes.
2. Bitches in season may run at the end of TESTS and at any time in TRIALS.
3. All HCT entries are required to be on AHBA's list of Accepted Herding Breeds. Mixes cannot enter HCT. ALL breeds and mixes may enter JHD and all Trial classes. Contact the Event Secretary if you have questions.

**NEW AHBA RULE - Effective June 1, 2010, no entry can be accepted without either a registration number or an AHBA Tracking Number** (note: you do not need both). Select your registration number, and use that consistently for all AHBA trials, also please be consistent in your dog's name on all entry forms to avoid any errors with your title progression. AHBA Tracking Number Request form is available at [www.shannonwolfeherding.com](http://www.shannonwolfeherding.com) under Events-AHBA; or from [www.ahba-herding.org](http://www.ahba-herding.org)

**FARM RULES:**

1. All dogs must be vaccinated for rabies as required by law, vaccinated for other communicable diseases as recommended by your veterinarian, and parasite free.
2. PICK UP AFTER YOUR DOGS.
3. All dogs must be on leash or crated except when working.
4. Extended Flexi-type leashes are not allowed on the farm. Keep your dog on a short leash.
5. There is very little shade at the farm. Plan accordingly. Water pools will be provided to cool your dog. (And bring yourself a chair!)
6. Spectators and their dogs should stay back at least 15 feet from the fence around any arena or field where a dog is working.
7. PICK UP AFTER YOUR DOGS.



**LIVESTOCK** - St. Croix/cross sheep; Pygmy/cross goats (\$150.00 value)  
Call Ducks & Rouen/cross ducks (\$25.00 value)

*Any livestock seriously injured while being worked must be paid for by the participant working stock at that time.*

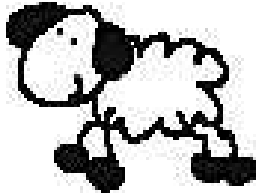

## DIRECTIONS

Genoa City, WI is 9 miles south of Lake Geneva, WI at the WI/IL border.

**From the North:** Take US Hwy 12 south until Freeway ends; follow exit to the stop sign and turn right (west) on Hwy H. Follow Hwy H to the first stop sign, which will be in downtown Genoa City. Turn left (south) at the stop sign onto Hwy B. Go 1 block and follow Hwy B as it turns to the right (west). Continue 1½ miles to farm, which is on your right.

**From the South:** Take US Hwy 12 north until you cross the WI/IL state line. About ¼ mile further Hwy 12 splits off to the right to begin the freeway; Hwy H bears to the left, which will take you into Genoa City. Continue as above.

## LOCAL MOTELS

It is always best to check hotels for any pet policies changes  
Super 8 - Richmond, IL

On US Hwy 12 approx. 3 miles from trial site.  
815-678-4711 — [www.saveinn.com](http://www.saveinn.com)

**Diplomat Motel** - Lake Geneva, WI

1060 Wells Street, Lake Geneva WI 53147  
262-248-2455 - <http://www.budgethost-lakegeneva.com/>

## FOOD ON SITE

We will be having a "Pot Luck" both days, if you would like to participate, please bring a dish to pass.. Hot and cold drinks will be available on site.

## WEBSITE

Check out the [www.shannonwolfeherding.com](http://www.shannonwolfeherding.com) for upcoming events, trials, tests, demonstrations, clinics, premiums, trial results, pictures, etc.



## JUST FOR THE FUN OF IT

(For Exhibition Only (FEO) Runs)

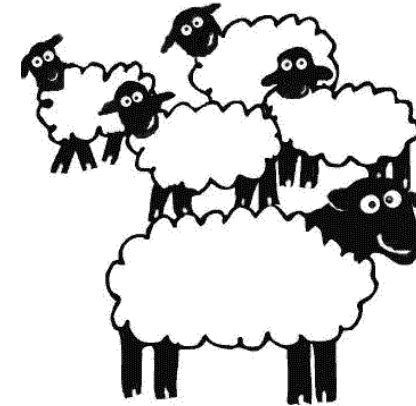

**Not ready to compete for one of the sanctioned AHBA classes? Want to give it a try anyway?**

Okay, here's your chance ... for \$25.00 per run, you can run your dog in a class for which he has already qualified. If you aren't ready to move up, you can practice the next level and help your dog without the handler line restrictions or the pressure of trying to qualify. You can practice with your dog under show conditions.

Fun runs will take place immediately after the competitive runs in conjunction with each class throughout the day.

When completing the Entry Form, please make sure you select FEO (For Exhibition Only) for your Fun Run.

Want more Information about FEO runs contact Shannon at [brass@genevaonline.com](mailto:brass@genevaonline.com)

## HTAD Course #2

## HTAD (Sheep & Goats) Course #2



### COURSE #2

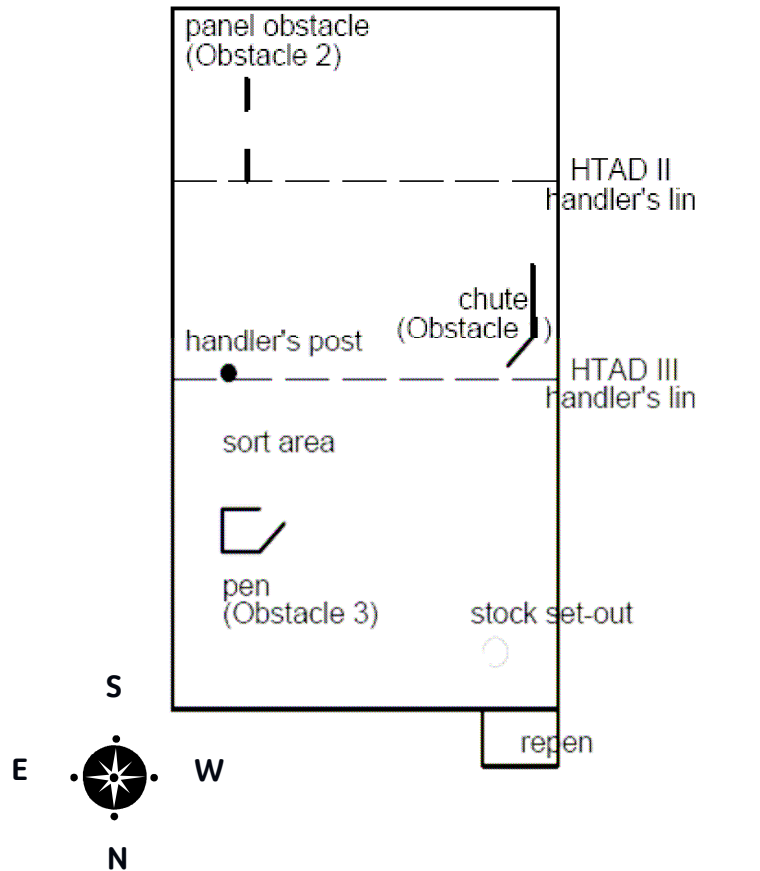

90/100 - 10 min. I & II; 12 min. III - 5 Animals  
Ties Determined by (1) gather/take-pen, (2) repen, (3) time

SAT - Take Pen; and at #6 - III will 3/2 Shed  
SUN - Gather; and at #6 - III will do a ribbon pull

### 1. Gather or Take-Pen

**Gather:** The stock are let out at the repen gate and allowed to settle. HTAD I handlers take the dog to a point approximately one-half the distance from the handler's post to the stock and leave the dog; the handler may move to approximately 15 ft. from the stock and send the dog to gather. HTAD II handlers leave the dog at the handler's post and move to a point approximately halfway between the post and the stock and send the dog to gather. HTAD III handlers and dogs stay at the handler's post, and the dog is sent from there to gather the stock. At all three levels the stock are brought to and around the handler's post, on the side between the post and the Y chute. The gather ends when the stock have gone just past the handler's post.

**Take-Pen:** HTAD III handlers must remain outside the pen while the dog brings out the stock. HTAD II handlers may enter the pen with the dog but should not move the stock themselves. HTAD I handlers may enter the pen and assist the dog in moving the stock. If the stock come out on their own volition without the handler or dog entering, there is no penalty. The stock are then taken to the point on the course where the handler's post would be located for the gather. Scoring for the take-pen ends when the stock have reached that point at which the handler's post would be located. The course then proceeds as indicated in the description.

### 2. Drive

The stock are taken **NORTH** between the **EAST** fence and the freestanding pen, then around the pen to a point just in front of the pen gate. Handlers at all levels may accompany the stock to this point. The stock are then driven to the Y chute. HTAD I handlers may accompany the dog and stock, fetching or driving or a combination of both. HTAD II handlers may accompany the stock and dog to a point halfway to the Y chute. HTAD III handlers must remain at the position in front of the pen while the stock are driven to the Y chute. The drive ends when the stock reach a point 10 ft. in front of the Y chute.

### 3. Obstacle 1

The stock are taken through the Y chute. HTAD II and III handlers remain at the designated location until the stock have cleared the Y chute. HTAD I handlers remain at the entrance of the Y chute until the stock have cleared it. Obstacle 1 ends when the stock have cleared the Y chute.

### 4. Obstacle 2

Upon the stock exiting the Y chute, HTAD I handlers may fetch or drive the stock through the freestanding panels, Obstacle 2 (none of the handlers may go through the panels). HTAD II handlers must stay on the post side of the handler's line (which runs across the width of the arena, even with the outside edge of the panel obstacle that is nearest the center of the arena) until the stock have cleared the panel obstacle. HTAD III handlers will remain behind a handler's line that runs the width of the arena even with the handler's post until the stock have cleared the panel obstacle. Once the stock have cleared the panel obstacle, the stock are turned to the left and taken to the pen; all handlers may take any position relative to the stock when going to the pen. Obstacle 2 ends when the stock have cleared the panels.

### 5. Obstacle 3

The stock are penned in the freestanding pen. Scoring for the pen gate is closed.

### 6. Sort

The animals are removed from the pen and taken to the sorting area. HTAD I and II handlers briefly hold the stock, then take them to the repen. For HTAD III handlers, the sort may be one of the following: (a) Gate sort of designated animals, (b) Ribbon-removal, or (c) Shed. The sort ends for HTAD I and II at the conclusion of the hold, and for HTAD III when the gate is closed on the sorted animals, or when the ribbon has been removed, or animals have been shed.

### 6. Repen

The stock are taken to the repen and held a short distance off the gate while it is opened, and then they are repenned. When a gate-sort has been used, the animals that had been left out in the arena are repenned. The run ends when the repen gate is closed.

## HTAD (Ducks) Course #2

(50' x100")

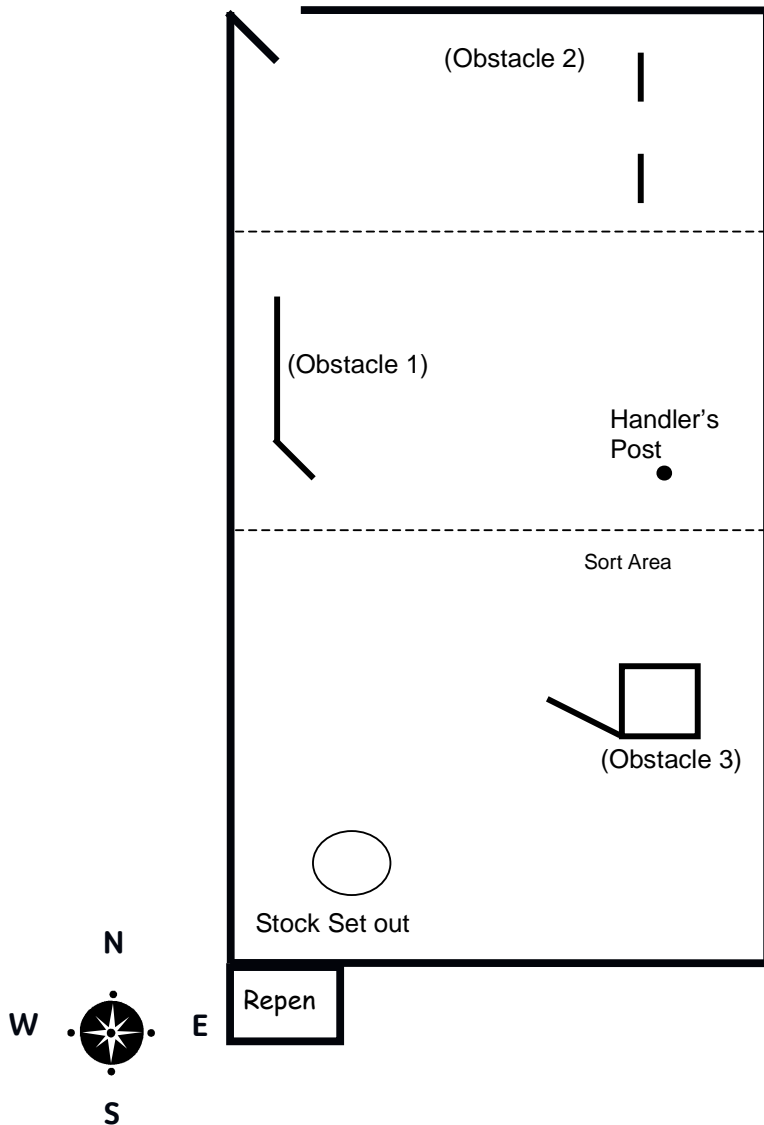

90/100 — 10 min. I & II; 12 min. III — 5 Ducks

Ties Determined by (1) Gather, (2) repen, (3) time

SAT. - Gather; and at #6, III does a 3/2 shed

SUN. - Gather; and at #6, III does a 3/2 shed

## HTAD (Ducks) Course #2

90/100 — 10 min. I & II; 12 min. III — 5 Ducks



1. Gather. The stock are set out in the Arena. HTAD I handlers take the dog to a point approximately one-half the distance from the handler's post to the stock and leave the dog; the handler may move to approximately 15 ft. from the stock and send the dog to gather. HTAD II handlers leave the dog at the handler's post and move to a point approximately halfway between the post and the stock and send the dog to gather. HTAD III handlers and dogs stay at the handler's post, and the dog is sent from there to gather the stock. At all three levels the stock are brought to and around the handler's post, on the side between the post and the Y chute. The gather ends when the stock have gone just past the handler's post.
2. Drive. The stock are taken **SOUTH** between the **WEST** fence and the freestanding pen, then around the pen to a point just in front of the pen gate. Handlers at all levels may accompany the stock to this point. The stock are then driven to the Y chute. HTAD I handlers may accompany the dog and stock, fetching or driving or a combination of both. HTAD II handlers may accompany the stock and dog to a point halfway to the Y chute. HTAD III handlers must remain at the position in front of the pen while the stock are driven to the Y chute. The drive ends when the stock reach a point 10 ft. in front of the Y chute.
3. Obstacle 1. The stock are taken through the Y chute. HTAD II and III handlers remain at the designated location until the stock have cleared the Y chute. HTAD I handlers remain at the entrance of the Y chute until the stock have cleared it. Obstacle 1 ends when the stock have cleared the Y chute.
4. Obstacle 2. Upon the stock exiting the Y chute, HTAD I handlers may fetch or drive the stock through the freestanding panels, Obstacle 2 (none of the handlers may go through the panels). HTAD II handlers must stay on the post side of the handler's line (which runs across the width of the arena, even with the outside edge of the panel obstacle that is nearest the center of the arena) until the stock have cleared the panel obstacle. HTAD III handlers will remain behind a handler's line that runs the width of the arena even with the handler's post until the stock have cleared the panel obstacle. Once the stock have cleared the panel obstacle, the stock are turned to the left and taken to the pen; all handlers may take any position relative to the stock when going to the pen. Obstacle 2 ends when the stock have cleared the panels.
5. Obstacle 3. The stock are penned in the freestanding pen. Scoring for the pen ends when the pen gate is closed.
7. Sort. The animals are removed from the pen and taken to the sorting area. HTAD I and II handlers briefly hold the stock, then take them to the repen. For HTAD III handlers, the sort may be one of the following: (a) Gate sort of designated animals, (b) Ribbon-removal, or (c) Shed. The sort ends for HTAD I and II at the conclusion of the hold, and for HTAD III when the gate is closed on the sorted animals, or when the ribbon has been removed, or animals have been shed.
6. Repen. The stock are taken to the repen and held a short distance off the gate while it is opened, and then they are repenned. When a gate-sort has been used, the animals that had been left out in the arena are repenned. The run ends when the repen gate is closed.

**HRD-I Sheep**

**HRD Course Map - All Levels**

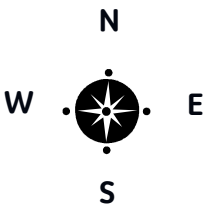
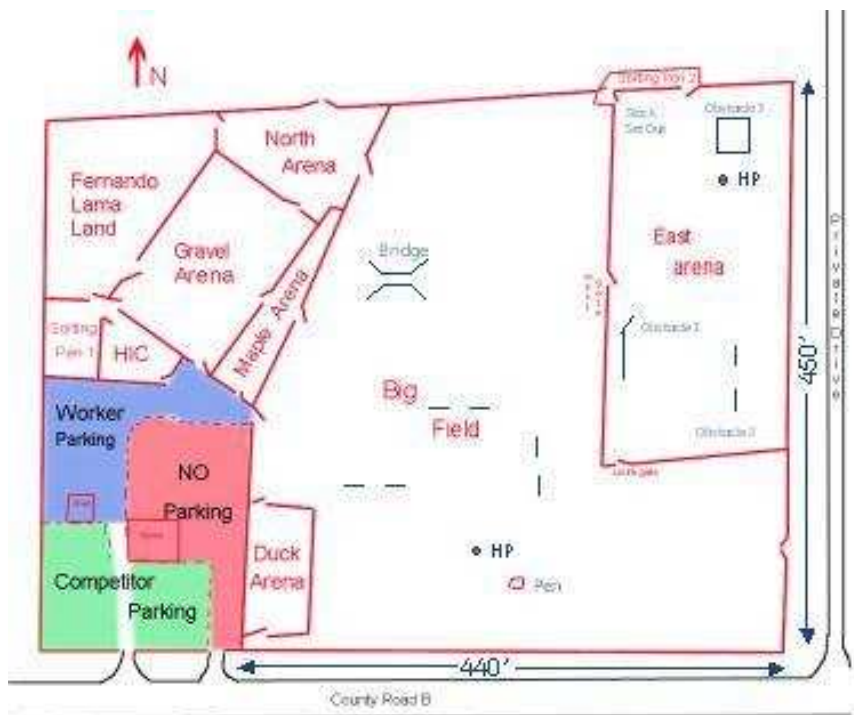

HRDI - 63/90 10 sheep - 15 MINUTES  
 Tiebreaker 1. Hold and touch, 2. Fetch and wear (#2)  
 HRDII - 63/90 10 sheep - 15 MINUTES  
 Tiebreaker: 1. Fetch, 2. Pen  
 HRDIII - 70/100 10 sheep - 15 MINUTES  
 Tiebreaker: 1. Move to Big Field (#3), 2. Bridge



- |  |        |
|--|--------|
|  | Points |
| 1. Handler may stand on the far side of the fetch gates. Dog is placed at handler's post. Handler sends dog on an outrun.  | 10     |
| 2. When sheep clear fetch panels, dog and handler are to make a left turn and wear sheep through the east set of panels, make a right turn, go clockwise around handlers post, wear through west panels, back across the field through the east panels again to HTAD arena. Handler may not walk through any panels. This will be judged on the sheep wearing on a straight line between obstacles as well as negotiating each obstacle. <b>TIEBREAKER (2)</b> | 20     |
| 3. Handler must sort 4 sheep into the south gate of the HTAD arena   | 10     |
| 4. Handler takes sheep and wear/drives the sheep down the road along the HTAD arena. At the end of the road, dog and handler are to make a left turn and take sheep to the bridge  | 5      |
| 5. Handler and sheep take sheep across bridge from east to west. Handler may cross bridge at any time.   | 10     |
| 6. Dog and handler wear/drive sheep from the bridge, through west panels to the free standing pen and pen all sheep. [ <b>Note: Points are based on sheep penned</b> ]   | 10     |
| 7. Dog and handler must take sheep to shedding ring. They must hold the sheep until the judge calls a hold and then touch the sheep the judge designates on the head. <b>TIEBREAKER (1)</b>  | 20     |
| 8. Reopen all sheep into HTAD arena  | 5      |



## HRD-II



Points

1. Dog is placed at handler's post. Handler may stand at the handler's post or  $\frac{1}{2}$  way between handler's post and fetch panels marked by white stake. Handler sends dog on outrun. After the dog is sent, Handler may move forward as far as the stake. 10
2. Dog is to fetch sheep through the fetch panels making a hard (dog's left, handler's right) turn and drive to east panels. Handler must stay at the stake during drive **TIEBREAKER (1)** 20
3. When the sheep have cleared the east gate, the handler may move back to the handler's post. Dog fetches sheep back to handler & make a clockwise turn around the handler's post. Dog must drive sheep through left (west) panel. Handler may walk BEHIND the dog during this drive. Handler may not walk through panel. 20
4. When sheep have cleared panel, handler & dog may wear/ drive sheep across the field through the east panel (handler may not walk through panel) to HTAD arena's south gate. 5
5. Handler must sort off 4 sheep into HTAD arena. 10
6. Handler & dog wear/drive remaining sheep to free standing pen & pen all sheep. (All sheep must be penned before handler can move on to next obstacle) **TIEBREAKER (2)** 10
7. Handler & dog take sheep out of freestanding pen, & take them over the bridge, from west to east. A straight-line path should be maintained between pen & bridge. Offline sheep will have points deducted. All sheep must cross bridge to continue. Handler must cross bridge after sheep have crossed. 10
8. Handler & dog wear/drive sheep to HTAD west arena gate & reopen them. 5



## HRD-III



Points

1. Take all sheep out of sorting pen. 10
2. Sort sheep into Maple Arena leaving 3 sheep in Gravel Arena 10
3. Gather sheep in Maple Arena & move through small gate into large field. Judged on quiet & controlled movement of stock through small gate. **TIEBREAKER (1)**. Allow sheep to escape in the Big Field after exiting gate. Spotter will pick up sheep & spot them in the Big Field. 5
4. Handler & dog must go to bridge & do an outrun to re-gather sheep. 10
5. Take sheep over bridge. Handler may walk over the bridge after the sheep. All sheep must go over bridge. Deductions taken for each missed attempt. Handler cannot go on until this obstacle is completed. **TIEBREAKER (2)** 10
6. Drive up road. Handler must stay at bridge until dog turns sheep towards panel drive line. 15
7. Drive sheep through left & right panels. Handler may not walk through panels. Handler may walk up to red handler's post in center of field until sheep go through the west panel. Then handler may start walking towards the freestanding pen. 15
8. Wear sheep to freestanding pen, & pen. Judge will okay it when sheep are penned. Dog & handler must let sheep out of pen & dog must remain under control while sheep escape 10
9. Dog must do outrun from freestanding pen & wear them into HTAD Arena. 15



# Ranch LARGE FLOCK Map

## RLF - III

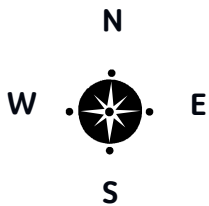
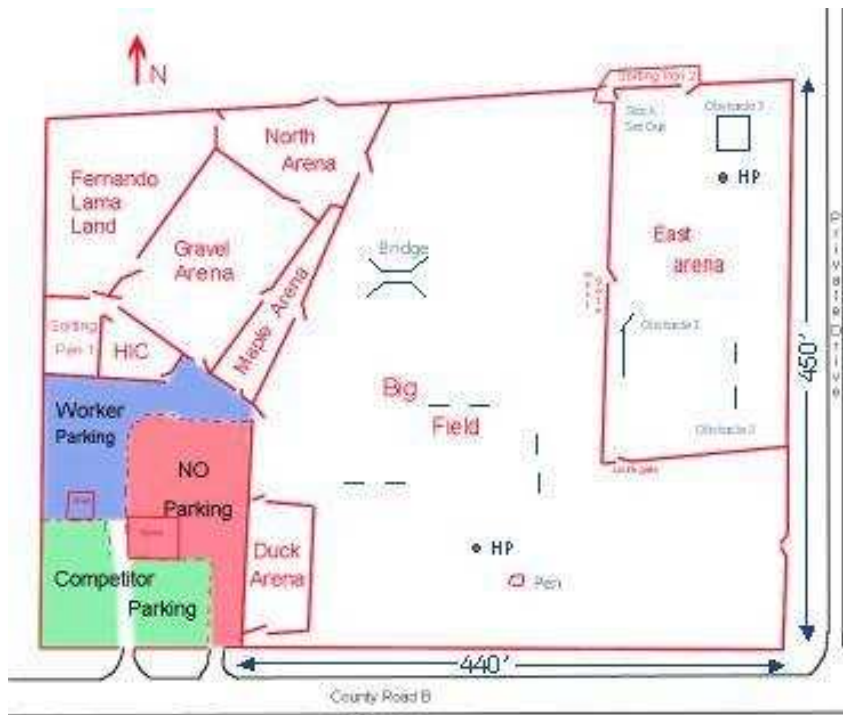

**RLF III**  
 70/100 Points - 20 minutes - based on first dog's time  
 30 Sheep  
 Ties broken by score of (1) Moving through side gate #4 (2) Time



- |   | Points |
|---|--------|
| 1. Gather all sheep from North Arena, with building, into gravel arena. Handler must stay at gate during gather.  | 10     |
| 2. Take (wear/drive) sheep through chute in center of Gravel Arena. Handler may not walk through chute.   | 10     |
| 3. Sort 25 sheep into Maple Arena, next to Gravel Arena   | 20     |
| 4. Take sheep into Big Field through side gate. Judged on controlled quiet movement of sheep through narrow gate. <b>TIEBREAKER.</b>  | 10     |
| 5. Stock handler picks up stock and sets them near center of North end of the Big Field. Dog and handler go to handler's post at the South end of the field near the freestanding pen. Dog and handler gather sheep and turn around handler's post clock wise turn and drive to left panel.   | 15     |
| 6. Handler must stay at handler's post. Dog must drive sheep through right panel.   | 15     |
| 7. Once sheep are through right panel, Handler has the dog turn the sheep left and drive sheep diagonally across field to the far Northwest corner of the Big Field. Handler may leave post when sheep clear right hand panel, but must stay on east side (HTAD Arena side) of the north south line made by the handler's and spotting post until sheep are at the corner. Dog holds sheep in northwest corner of Big Field along fence off gate until handler arrives. | 15     |
| 8. Pen sheep into North Arena. Pen judged by controlled movement of stock through gate.   | 5      |



**THIS MUST BE SIGNED BEFORE ENTRY CAN BE ACCEPTED.**

**Entry Agreement and Indemnity**

The person who signs this Entry represents that she/he is authorized to enter into this Agreement and Indemnity on behalf of both the Handler and Owner of the entered dog in consideration of acceptance of this entry.

Handler and Owner whether or not members of American Herding Breed Association ("AHBA") agrees to abide by the rules and regulations of AHBA and all other rules and/or regulations shown in the premium list for this event.

Handler and Owner certify that the entered dog is not a hazard to persons, dogs or property. In the event the entered dog injures any livestock, the owner will pay for veterinarian services. If the injury is severe, the owner will pay the market value or value stated in the premium list of the stock injured.

Handler and Owner acknowledge that herding events are inherently dangerous and have risks of injury to persons. Handler and Owner agree to assume the risk of any harm arising from the hazards associated with the herding event which include but are not limited to, parking areas, ground conditions, animals, stock used in the herding event, and other dogs.

Handler and Owner hereby release AHBA, its officers, directors agents and members, including Shannon Wolfe, Magic's Legacy (its officers, agents and directors) and the owners of the site of the event, from any and all liability for any injury, loss or damage, of whatever kind or nature, whether to person or property which occurs directly or indirectly or associated with the herding event.

Handler and Owner agrees to indemnify and hold harmless AHBA, its officers, directors agents and members, including Shannon Wolfe, Magic's Legacy (its officers, agents and directors) and the owners of the site of the event, from any and all claims, loss or expense, including attorney's fees, arising out of any injury, loss or damage, of whatever kind or nature, whether to person or property which occurs directly or indirectly or associated with acts or failure to act of Handler or Owner, or any of the dogs entered in the herding event or brought to the site of the herding event.

\_\_\_\_\_  
Signature of Entrant

\_\_\_\_\_  
Date

**ENTRY FORM**

Magic's Legacy AHBA Tests/Trials June 26 & 27, 2010  
Fee enclosed: \$ \_\_\_\_\_ **Pre-entries close Saturday June 12, 2010**

**Make checks payable to MAGIC'S LEGACY.** Mail completed entry form with fees to Event Secretary Loralie Van Slyus 432 Inverrary Lane, Deerfield, IL 60015. **No acknowledgements will be sent.** Pre-entries are \$40/class. Gate entries are \$45/class. FEO entries \$25/class.

**NOTE: Changes made after the closing date are subject to an additional \$5.00 admin fee.**

Check the box for the classes you want to enter and CIRCLE the Level, Stock and Leg/CH.

DAY	CLASS	LEVEL	STOCK	LEG/CH	FEO*
<input type="checkbox"/> SAT	HTAD	I II III	Sheep Goats Ducks	CH	FEO
<input type="checkbox"/> SAT	HRD	I II III	Sheep	CH	FEO
<input type="checkbox"/> SAT	HTD	I II III	Sheep Goats Ducks	CH	FEO
<input type="checkbox"/> SAT	RLF	III	Sheep	CH	
<input type="checkbox"/> SAT	JHD	- - - - -	Sheep Goats		FEO
<input type="checkbox"/> SAT	HCT	- - - - -	Sheep Goats	1 2	
<input type="checkbox"/> SUN	HTAD	I II III	Sheep Goats Ducks	CH	FEO
<input type="checkbox"/> SUN	HRD	I II III	Sheep	CH	FEO
<input type="checkbox"/> SUN	HTD	I II III	Sheep Goats Ducks	CH	FEO
<input type="checkbox"/> SUN	RLF	III	Sheep	CH	
<input type="checkbox"/> SUN	JHD	- - - - -	Sheep Goats		FEO
<input type="checkbox"/> SUN	HCT	- - - - -	Sheep Goats	1 2	

\*For Exhibition Only (FEO) runs are allowed (if room). \*Limited Goat Entries-early entry recommended

Breed \_\_\_\_\_

Registered Name (Please use the same name for all AHBA Entries) \_\_\_\_\_

Reg. Number/Tracking Number (please use the same number for all AHBA Entries) \_\_\_\_\_

**NOTE: NO ENTRY CAN BE ACCEPTED WITHOUT EITHER A REGISTRATION NUMBER (i.e. AKC, ABCA, ASCA), OR AN AHBA TRACKING NUMBER.** An AHBA Tracking Number can be obtained by completing the request form on the AHBA website, and mailing it in. <http://www.ahba-herding.org/>.

Call Name \_\_\_\_\_ Sex \_\_\_\_\_ Birthdate \_\_\_\_\_

Sire \_\_\_\_\_

Dam \_\_\_\_\_

Name of Breeder \_\_\_\_\_

Name of Owner \_\_\_\_\_

Address \_\_\_\_\_

Name of Handler \_\_\_\_\_

Day Phone # (\_\_\_\_\_) \_\_\_\_\_ Evening Phone # (\_\_\_\_\_) \_\_\_\_\_

E-mail \_\_\_\_\_

**ENTRIES WILL NOT BE ACCEPTED unless the disclaimer on the reverse side of this entry form is signed by the Entrant.**

**THIS MUST BE SIGNED BEFORE ENTRY CAN BE ACCEPTED.**

**Entry Agreement and Indemnity**

The person who signs this Entry represents that she/he is authorized to enter into this Agreement and Indemnity on behalf of both the Handler and Owner of the entered dog in consideration of acceptance of this entry.

Handler and Owner whether or not members of American Herding Breed Association ("AHBA") agrees to abide by the rules and regulations of AHBA and all other rules and/or regulations shown in the premium list for this event.

Handler and Owner certify that the entered dog is not a hazard to persons, dogs or property. In the event the entered dog injures any livestock, the owner will pay for veterinarian services. If the injury is severe, the owner will pay the market value or value stated in the premium list of the stock injured.

Handler and Owner acknowledge that herding events are inherently dangerous and have risks of injury to persons. Handler and Owner agree to assume the risk of any harm arising from the hazards associated with the herding event which include but are not limited to, parking areas, ground conditions, animals, stock used in the herding event, and other dogs.

Handler and Owner hereby release AHBA, its officers, directors agents and members, including Shannon Wolfe, Magic's Legacy (its officers, agents and directors) and the owners of the site of the event, from any and all liability for any injury, loss or damage, of whatever kind or nature, whether to person or property which occurs directly or indirectly or associated with the herding event.

Handler and Owner agrees to indemnify and hold harmless AHBA, its officers, directors agents and members, including Shannon Wolfe, Magic's Legacy (its officers, agents and directors) and the owners of the site of the event, from any and all claims, loss or expense, including attorney's fees, arising out of any injury, loss or damage, of whatever kind or nature, whether to person or property which occurs directly or indirectly or associated with acts or failure to act of Handler or Owner, or any of the dogs entered in the herding event or brought to the site of the herding event.

\_\_\_\_\_  
Signature of Entrant

\_\_\_\_\_  
Date

**ENTRY FORM**

Magic's Legacy AHBA Tests/Trials June 26 & 27, 2010  
Fee enclosed: \$ \_\_\_\_\_ **Pre-entries close Saturday June 12, 2010**

**Make checks payable to MAGIC'S LEGACY.** Mail completed entry form with fees to Event Secretary Loralie Van Slyus 432 Inverrary Lane, Deerfield, IL 60015. **No acknowledgements will be sent.** Pre-entries are \$40/class. Gate entries are \$45/class. FEO entries \$25/class.

**NOTE: Changes made after the closing date are subject to an additional \$5.00 admin fee.**

Check the box for the classes you want to enter and CIRCLE the Level, Stock and Leg/CH.

DAY	CLASS	LEVEL	STOCK	LEG/CH	FEO*
<input type="checkbox"/> SAT	HTAD	I II III	Sheep Goats Ducks	CH	FEO
<input type="checkbox"/> SAT	HRD	I II III	Sheep	CH	FEO
<input type="checkbox"/> SAT	HTD	I II III	Sheep Goats Ducks	CH	FEO
<input type="checkbox"/> SAT	RLF	III	Sheep	CH	
<input type="checkbox"/> SAT	JHD	- - - - -	Sheep Goats		FEO
<input type="checkbox"/> SAT	HCT	- - - - -	Sheep Goats	1 2	
<input type="checkbox"/> SUN	HTAD	I II III	Sheep Goats Ducks	CH	FEO
<input type="checkbox"/> SUN	HRD	I II III	Sheep	CH	FEO
<input type="checkbox"/> SUN	HTD	I II III	Sheep Goats Ducks	CH	FEO
<input type="checkbox"/> SUN	RLF	III	Sheep	CH	
<input type="checkbox"/> SUN	JHD	- - - - -	Sheep Goats		FEO
<input type="checkbox"/> SUN	HCT	- - - - -	Sheep Goats	1 2	

\*For Exhibition Only (FEO) runs are allowed (if room). \*Limited Goat Entries-early entry recommended

Breed \_\_\_\_\_

Registered Name (Please use the same name for all AHBA Entries)  
\_\_\_\_\_

Reg. Number/Tracking Number (please use the same number for all AHBA Entries) \_\_\_\_\_

**NOTE: NO ENTRY CAN BE ACCEPTED WITHOUT EITHER A REGISTRATION NUMBER (i.e. AKC, ABCA, ASCA), OR AN AHBA TRACKING NUMBER.** An AHBA Tracking Number can be obtained by completing the request form on the AHBA website, and mailing it in. <http://www.ahba-herding.org/>.

Call Name \_\_\_\_\_ Sex \_\_\_\_\_ Birthdate \_\_\_\_\_

Sire \_\_\_\_\_

Dam \_\_\_\_\_

Name of Breeder \_\_\_\_\_

Name of Owner \_\_\_\_\_

Address \_\_\_\_\_

Name of Handler \_\_\_\_\_

Day Phone # (\_\_\_\_\_) \_\_\_\_\_ Evening Phone # (\_\_\_\_\_) \_\_\_\_\_

E-mail \_\_\_\_\_

**ENTRIES WILL NOT BE ACCEPTED unless the disclaimer on the reverse side of this entry form is signed by the Entrant.**